

# TOWER®

BUILT FOR **BETTER** SINCE 1912

## **VL30EVO**

22.2V CORDLESS 3-IN-1 VACUUM CLEANER

MODEL: T513013



## USER MANUAL



GREAT BRITISH DESIGN, INNOVATION AND EXCELLENCE

# TABLE OF CONTENTS

---

<b>IMPORTANT SAFETY INFORMATION</b>	<b>3-6</b>
<b>THIS BOX CONTAINS</b>	<b>7</b>
<b>SPECIFICATIONS</b>	<b>7</b>
<b>STRUCTURE OF YOUR APPLIANCE</b>	<b>8</b>
<b>BEFORE FIRST USE</b>	<b>9</b>
<b>USING YOUR APPLIANCE</b>	<b>9-10</b>
· Assembling the appliance	<b>9</b>
· Wall mounting	<b>9</b>
· Charging the appliance	<b>9</b>
· How to use your appliance	<b>10</b>
· Vacuum cleaner LED display	<b>10</b>
· Accessories	<b>10</b>
<b>TROUBLESHOOTING</b>	<b>11</b>
<b>CLEANING AND CARE</b>	<b>11-12</b>
<b>DISPOSAL OF THE UNIT / CUSTOMER SUPPORT</b>	<b>13</b>

## IMPORTANT SAFETY INFORMATION

---

Please read these safety notes carefully before using your Tower appliance.

These warnings have been provided in the interest of safety. Basic safety precautions should always be followed including the following:

### GENERAL SAFETY

- Check that the voltage of the main circuit corresponds with the rating of the appliance before operating.
- If the supply cord or appliance is damaged, stop using the appliance immediately and seek advice from the manufacturer, its service agent or a similarly qualified person.
- **DO NOT** let the cord hang over the edge of a table or counter or let it come into contact with any hot surfaces.
- **DO NOT** carry the appliance by the adaptor cord.
- **DO NOT** use any extension cord with this appliance.
- **DO NOT** pull the adaptor out by the cord as this may damage the plug and/or the cable.
- Switch off at the wall socket then remove the plug from the socket when not in use or before cleaning.
- Switch off and unplug before fitting or removing tools/ attachments, after use and before cleaning.
- Close supervision is necessary when any appliance is used by or near children.
- Children should not play with the appliance.
- This appliance can be used by children aged from 8 years and above and persons with reduced physical, sensory or mental capabilities or lack of experience and knowledge if they have been given supervision or instruction concerning use of the appliance in a safe way and understand the hazards involved.
- Cleaning and user maintenance should not be undertaken by children without supervision.
- Take care when any appliance is used near pets.

## IMPORTANT SAFETY INFORMATION

---

- Not suitable for carpets with long fibres as the bristles will damage the fibres.
- Keep the vacuum cleaner moving over the carpet surface at all times to avoid damaging the carpet fibres.
- **DO NOT** use this product for anything other than its intended use.
- **DO NOT** immerse cords, plugs or any part of the appliance in water or any other liquid.
- This appliance is for household use only.
- **DO NOT** use the appliance outdoors.
- Keep hair, loose clothing, fingers and all body parts away from moving parts.
- **DO NOT** use to pick up flammable liquids such as gasoline or use in an area where they might be present.
- **DO NOT** use the appliance without the dust container filter in place.
- This product is fitted with a thermal cut-out, which will activate if the motor overheats due to blocked air inlets. If the appliance cuts out, allow it to cool for 1 hour, then empty the dust container and clean all of the filters.
- **DO NOT** pick up anything that is burning or smoking such as cigarettes, matches or hot ashes.
- Use extra care when cleaning on stairs.
- The use of accessory attachments is not recommended by the appliance manufacturer apart from those supplied with this product. **DO NOT** use extension cords with the appliance.
- **DO NOT** pull the cord, use the cord as a handle, close a door on the cord, or pull the cord around sharp edges or corners.
- **DO NOT** run the vacuum cleaner over any electrical cables.

## IMPORTANT SAFETY INFORMATION

---

### ADDITIONAL BATTERY SAFETY PRECAUTIONS

- **DO NOT** use a battery pack or appliance that is damaged or modified. Damaged or modified batteries may exhibit unpredictable behaviour resulting in fire, explosion or risk of injury.
- **DO NOT** expose the battery pack or appliance to fire or excessive temperatures. Exposure to fire or temperatures above 60°C (140°F) may cause an explosion.
- The battery is a sealed unit and under normal circumstances poses no safety concerns. In the unlikely event that liquid leaks from the battery, **DO NOT** touch the liquid as it may cause irritation or burns to the skin, eyes or nose. Should battery liquid come in contact with skin, immediately wash the affected area with soap and water. In case of eye contact, immediately flush your eyes thoroughly with water for at least 15 minutes and seek medical attention.
- In case of inhalation, immediately expose to fresh air and seek out medical advice.
- Disposal: Wear gloves to handle the battery. Dispose of it immediately, following local ordinances or regulations.
- Follow all charging instructions and **DO NOT** charge the battery pack or the appliance outside of the temperature range specified in the instructions. Charging improperly or at a temperature outside of the specified range may damage the battery and increase the risk of fire. To ensure maximum battery life, observe the following guidelines:
  - When not in use the appliance should be stored at room temperature. Recommended range: 18°C (64°F) to 28°C (82°F).
  - The ambient temperature range for operation and charging should be 10°C (50°F) to 30°C (86°F).
- **FIRE WARNING – DO NOT** place this product on or near a cooker or any other hot surface and **DO NOT** incinerate this appliance

## IMPORTANT SAFETY INFORMATION

---

even if it is severely damaged. The battery might catch fire or explode.

- **FIRE WARNING – DO NOT** apply any fragrance or scented product to the filter(s) of this appliance. The chemicals in such products are known to be flammable and can cause the appliance to catch fire.

### PLUG AND CORD

- If the supply cord or appliance is damaged, stop using the appliance immediately and seek advice from the manufacturer, its service agent or a similarly qualified person.
- **DO NOT** immerse cords, plugs or any part of the appliance in water or any other liquid.
- Switch off and unplug before fitting or removing tools/ attachments, when not in use and before cleaning. Allow to cool before assembly or disassembly occurs.

- **DO NOT** let the cord hang over the edge of a table or counter or let it come into contact with any hot surfaces.
- **DO NOT** pull the plug out by the cord as this may damage the plug and/or the cable.
- **DO NOT** carry the appliance by the charging cord.
- Keep the charging cord away from sharp edges and prevent from being pinched between objects, such as a door.
- **DO NOT** handle the plug or the vacuum cleaner with wet hands.
- **DO NOT** insert any objects into openings in the unit.

It is important that this instruction manual is retained for future reference.

If the appliance is given to someone else, it should always be accompanied by these operating instructions, as they form an integral part of the appliance.

## THIS BOX CONTAINS

---

Instruction Manual

Power adaptor

Main unit

Battery

Floorhead

Aluminium tube

Wall mount

Crevice tool

Upholstery brush



## SPECIFICATIONS

---

RATED VOLTAGE	220-240V
FREQUENCY	50/60Hz
PRODUCT POWER	150W DC motor
BATTERY PACK	22.2V 2200mAh Detachable (Li-Ion)
CHARGING TIME	4-5 hours
RUN TIME FROM FULL CHARGE	20-40 minutes

## STRUCTURE OF YOUR APPLIANCE

1. Motor
2. Battery Pack
3. Dust Tank
4. Dust Tank Cover Release Button
5. Pole Release Button
6. Aluminium Tube
7. Brush Head Release Button
8. Brush Head
9. Brush Tool
10. Crevice Tool
11. Wall Mount

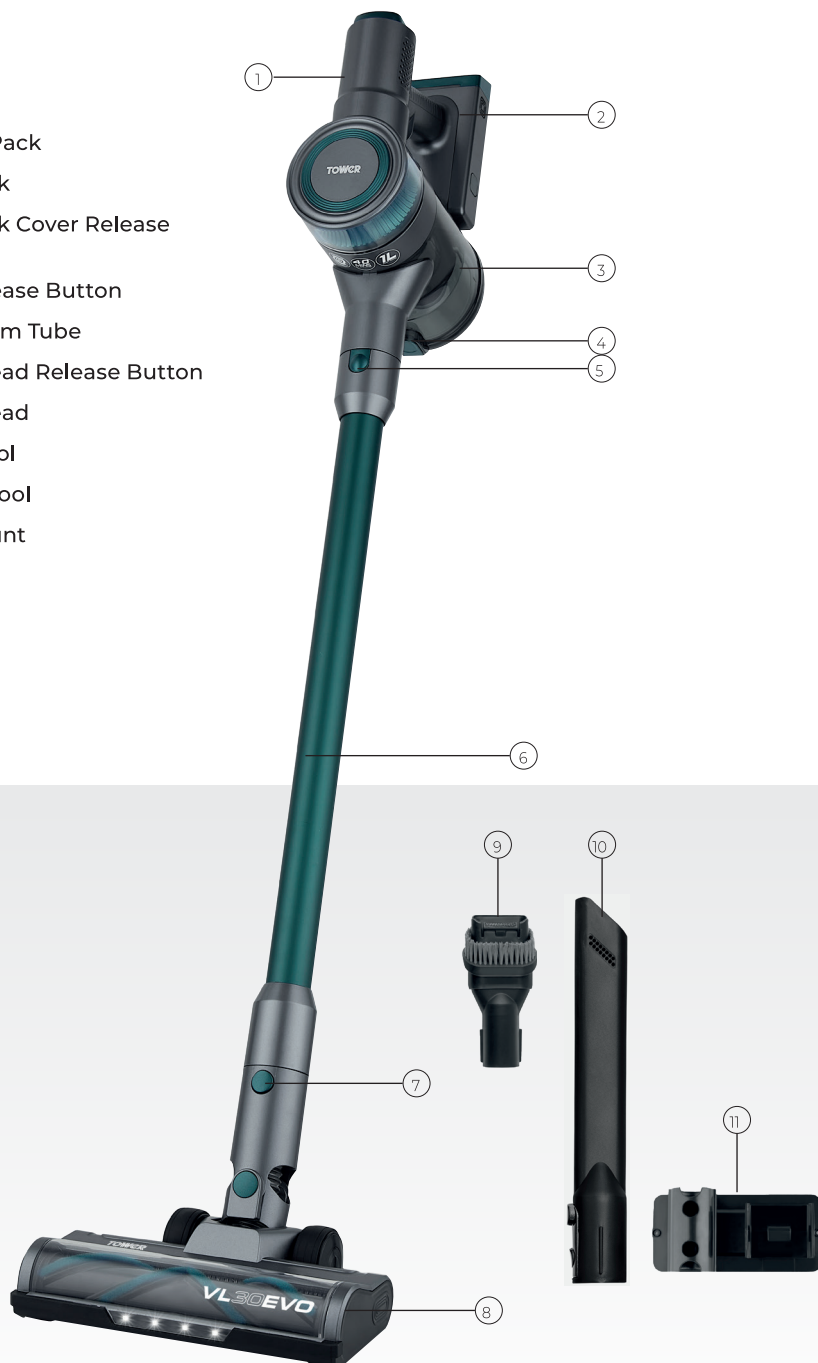



## BEFORE FIRST USE

---

### PREPARING FOR USE:

1. Remove the product from the box.
2. Remove any packaging from the product.
3. Please retain all packaging until you have checked and counted all the parts and the contents against the parts list.
4. Dispose of the packaging in a responsible manner

## USING YOUR APPLIANCE

---

### ASSEMBLING THE APPLIANCE:

1. Push the battery pack into the main unit until an audible click is heard.

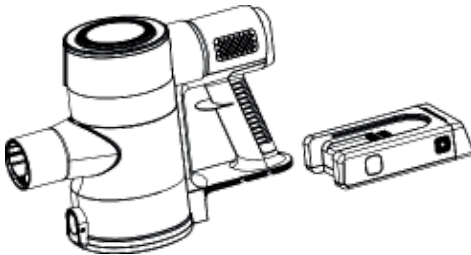

All accessories such as the aluminium aluminium tube and floorhead assemble and disassemble via the use of buttons (see *Structure of your appliance section for button locations*). In the case of assembly, simply slot the two items together and you will hear the button click in place once the two items are correctly assembled. To disassemble, simply press the button and pull the two items apart.

### WALL MOUNTING:

You may store your vacuum on the wall with the use of the wall mount. Simply find a convenient spot on the wall which is high enough off the floor to allow the main unit with floorhead and aluminium tube to hang above the floor when attached to the main unit.



1. Ensure that the part of the wall which you are drilling into is free of any wiring or plumbing with the use of a wall detector.
2. Mark out the holes on the wall mount with a pencil onto the wall which you are drilling with, and then drill two pilot holes.
3. Attach the wall mount with the use of wall plugs and screws.
4. Ensure that the wall mount is fully secure before use.

### CHARGING THE APPLIANCE:

To charge the appliance, plug the adaptor into the mains, ensuring that the mains supply is turned on.

**Note:** the battery pack may be charged when it is either connected or disconnected from the unit. To remove the battery pack from the main unit, simply press the button on the side of the battery pack and then slide it off the main unit.

1. Plug the adaptor into the socket in the battery pack. You will know when the unit is charging as the LED display atop the main body will display the battery percentage.
2. The battery pack will also flash white when charging, and then display a continuous white light when fully charged.

## USING YOUR APPLIANCE

---

### HOW TO USE THE APPLIANCE:

- Add any attachments and hold the unit by the pistol grip. Simply press the power On/Off button to begin vacuuming, and then press it again to stop the unit's operation.
- The vacuum has two speed settings; LOW mode and HIGH mode. The slower the mode, the longer the charge of the battery will last. To select in-between these modes, simply press the +/- button, located just below the power On/Off button above the pistol grip on the main unit.
- When LOW is selected, the green fan icon on the left hand side will light up.
- When HIGH is selected, the red fan icon on the right hand side will light up.

### VACUUM CLEANER LED DISPLAY:

1. LOW mode indicator
2. LED battery percentage display
3. HIGH mode indicator
4. Mode select button
5. Power On/Off button



### ACCESSORIES:

(see *Structure of your appliance* section).

**Brushhead:** Used for day-to-day vacuuming. LED light included in the floorhead to help illuminate darker corners.

**Crevice Tool:** Designed to access small crevices and hard-to reach areas.

**Brush Tool:** Adjustable upholstery brush designed to clean fabric such as sofas and seats.

# TROUBLESHOOTING

PROBLEM	SOLUTION
The vacuum will not work	Ensure the vacuum cleaner is fully charged. Check that there are no blockages to the dust tank or filter and remove as necessary
The vacuum will not pickup or the suction power is weak	The dust tank may be full, or the filters may require cleaning. Empty the dust tank and clean the filters. There may be blockages in the filters or dust tank. Check for blockages and clean the filters and dust tank as detailed in the 'Cleaning and Care' section.
Dust is escaping from the vacuum	The filter may not be installed correctly, or the dust tank may be full. Empty the dust tank and reassemble the filter system.
The vacuum is making an unusual sound or hissing	The airflow may be restricted or blocked. Check for blockages and clean the filters and pole as detailed in the 'Cleaning and Care' section.

## CLEANING AND CARE

### EMPTYING THE DUST TANK AND CLEANING THE HEPA FILTER:

1. Press the dust tank release button to open the dust tank's door. Empty out any dust and debris into a bin or other appropriate receptacle.

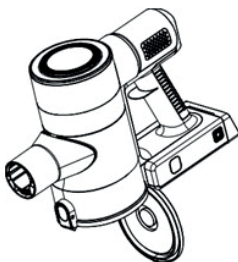

2. To clean the HEPA filter, twist the filter housing (located inside the dust tank) anti-clockwise and pull it away from the unit. The HEPA filter is located on the top of the filter housing.
3. Twist the HEPA filter anticlockwise until it pops out.
4. Clean both the HEPA filter and the filter housing either by picking out

debris, or by washing them both. Ensure they are both completely dry before reinstalling.

5. To reinstall, place the cylindrical HEPA filter back in the housing and twist clockwise until there is an audible click. The HEPA filter should not be able to move.

### CLEANING THE FLOORHEAD:

1. Pull the lock button located on the bottom of the floorhead and pull the longitudinal tab which holds the brush in place. Slide out the roller brush sideways.
2. Remove dirt and debris on the floorhead and roller brush.
3. Once clean, reverse the process of disassembly. Simply slide the roller brush back into the floorhead, ensuring that the endpiece of the brush slots into place. Push the longitudinal tab back down onto the floorhead until an audible click is heard.

## CLEANING AND CARE

---

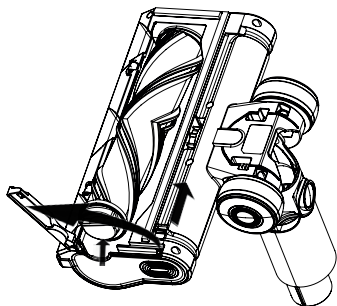

### CLEARING BLOCKAGES:

If the dust tank is overfilled, the filter is clogged up, or the vacuum picks up a larger piece of debris, the vacuum may become clogged.

Should this occur, carry out the following steps to unclog the vacuum:

1. Check the dust tank and empty it if necessary.
2. Check the filter for any debris and rinse it under running water if necessary, as detailed in the sections above.
3. Detach any attachments from the unit and check for blockages.

### STORAGE

**Note:** Before storing the vacuum, unplug it from the mains and remove any attachments from the front of the unit.

**Note:** To prolong battery life and ensure safe storage, take care to observe the battery safety precautions outlined in the corresponding section of this manual before storing the unit.

- Store the appliance in a cool, dry place, preferably using the wall mount, or inside its original packaging, and out of the reach of children.

**WARNING:** Do not immerse any electrical part of the appliance in water such as motor units or plugs. Please see cleaning section for further instructions.

## DISPOSAL OF THE UNIT

---

Appliances bearing the symbol shown here may not be disposed of in domestic rubbish. You are required to dispose of old electrical and electronic appliances like this separately.

Please visit [www.recycle-more.co.uk](http://www.recycle-more.co.uk) or [www.recyclenow.co.uk](http://www.recyclenow.co.uk) for access to information about the recycling of electrical items.

Please visit [www.weeeireland.ie](http://www.weeeireland.ie) for access to information about the recycling of electrical items purchased in Ireland.

The WEEE directive, introduced in August 2006, states that **all** electrical items must be recycled, rather than taken to landfill.

Please arrange to take this appliance to your local Civic Amenity site for recycling, once it has reached the end of its life.



## CUSTOMER SUPPORT

---

If you have any questions or concerns about your new product, please contact our helpful Customer Support Team:



**+44 (0) 333 220 6066**



**[www.towerhousewares.co.uk](http://www.towerhousewares.co.uk)**

Please have your Model No. available. This can be found on the front cover of this instruction manual and on the appliance's rating label.





# TOWER®

BUILT FOR BETTER SINCE 1912

## *thank you!*

We hope you enjoy your appliance for many years...

This product is guaranteed for 12 months from the date of original purchase.

If any defect arises due to faulty materials or workmanship, the faulty products must be returned to the place of purchase.

Refund or replacement is at the discretion of the retailer.

#### THE FOLLOWING CONDITIONS APPLY:

The product must be returned to the retailer with proof of purchase or a receipt.

The product must be installed and used in accordance with the instructions contained in this instruction guide.

It must be used only for domestic purposes.

It does not cover wear and tear, damage, misuse or consumable parts.

Tower has limited liability for incidental or consequential loss or damage.

This guarantee is valid in the UK and Eire only.

The standard one year guarantee is only extended to the maximum available for each particular product upon

registration of the product within 28 days of purchase. If you do not register the product with us within the 28 day period, your product is guaranteed for 1 year only.

To validate your extended warranty, please visit **[www.towerhousewares.co.uk](http://www.towerhousewares.co.uk)** and register with us online.

Please note that length of extended warranty offered is dependent on product type and that each qualifying product needs to be registered individually in order to extend its warranty past the standard 1 year.

Extended warranty is only valid with proof of purchase or receipt.

Your warranty becomes void should you decide to use non Tower spare parts.

Spare parts can be purchased from **[www.towerhousewares.co.uk](http://www.towerhousewares.co.uk)**

Or call our Customer Support Team on:  
**+44 (0) 333 220 6066**

